

Top View

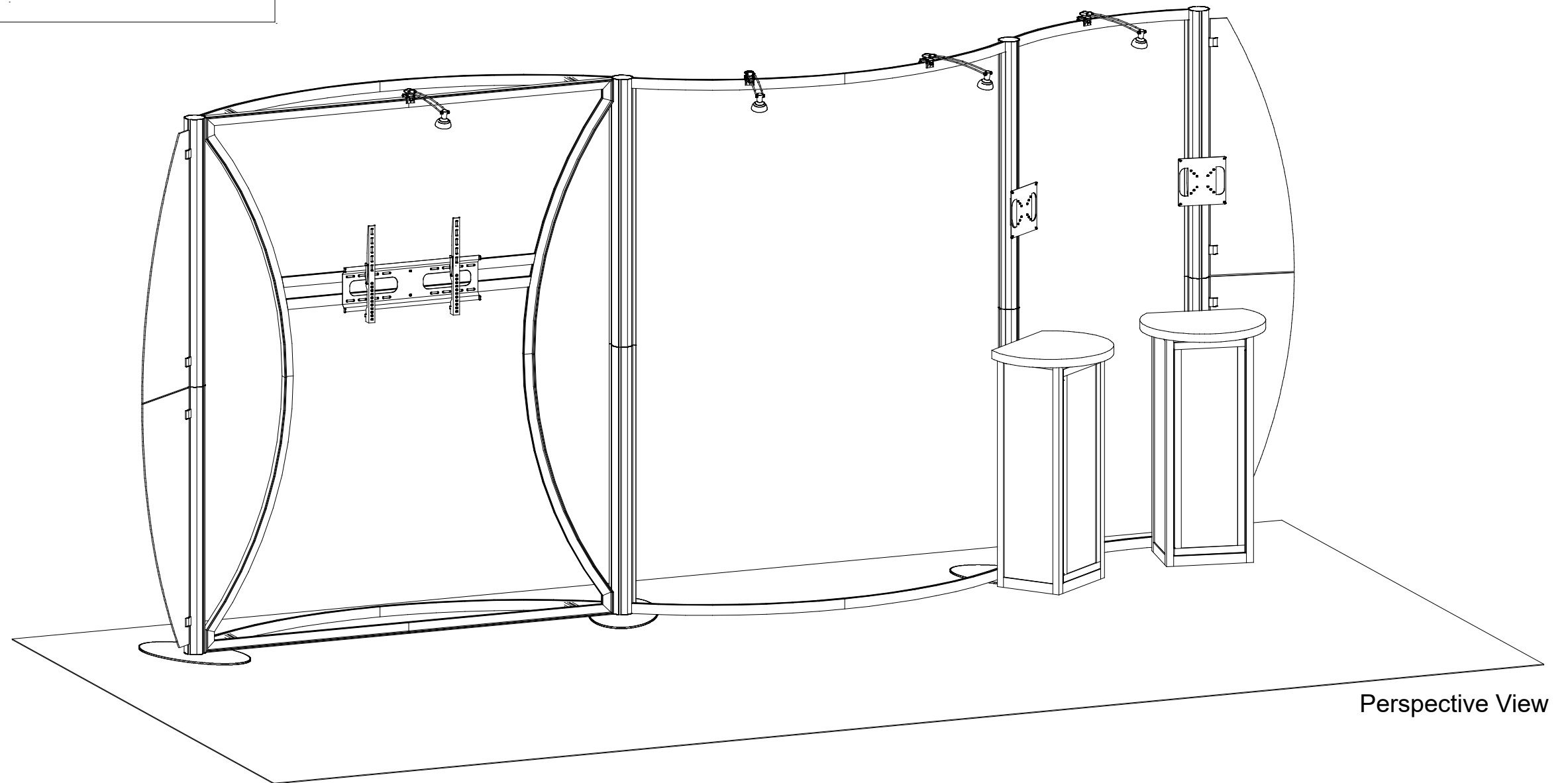

General Setup Instructions

- Read entire setup instruction manual prior to unpacking parts and pieces.
- The setup instructions are created specifically for this configuration.
- Setup instructions are laid out sequentially in steps, including exploded views with detailed explanation for assembly.

Cleaning & Packing

- For Cleaning Metal, Plex, & Laminate Parts: Use a **MILD NON-ABRASIVE** cleanser and soft cloth/paper towel to clean all surfaces.
- Keep exhibit components away from heat and prolonged sun exposure. **Heat and UV exposure will warp and fade components.**
- Retain all provided Packing Materials. All provided packing materials are for ease of repacking & component protection.

Disassembly

- For loss prevention, tighten all set screws and locks during disassembly.

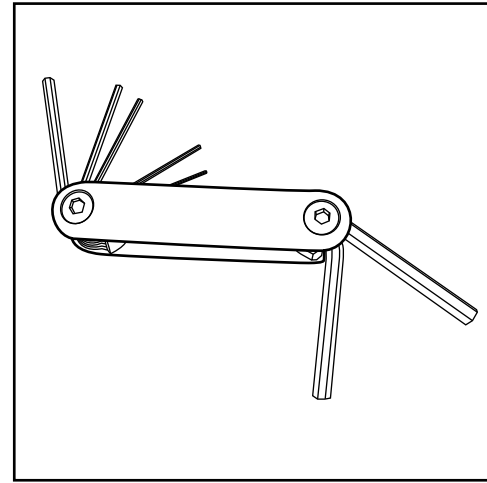

Hex Tool - Essential for Assembly

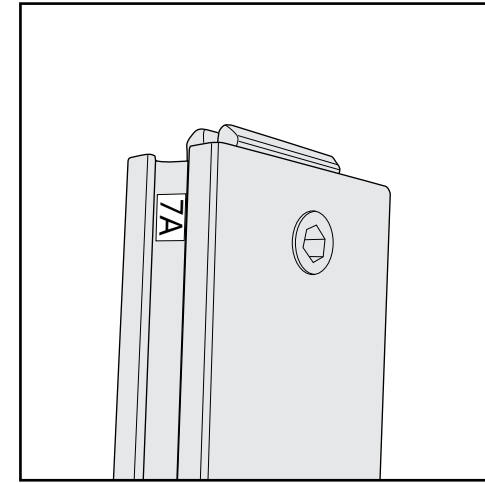

Part Identification - Numbering

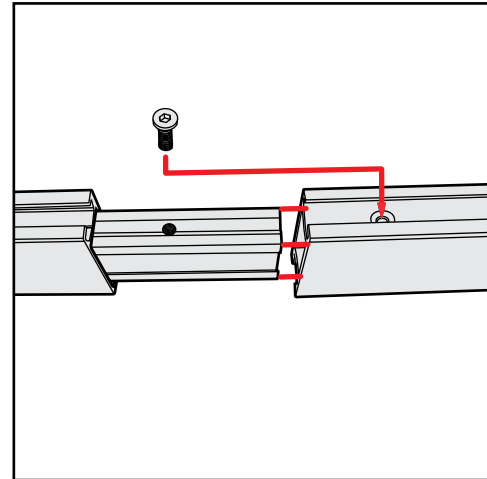

Spline Connection

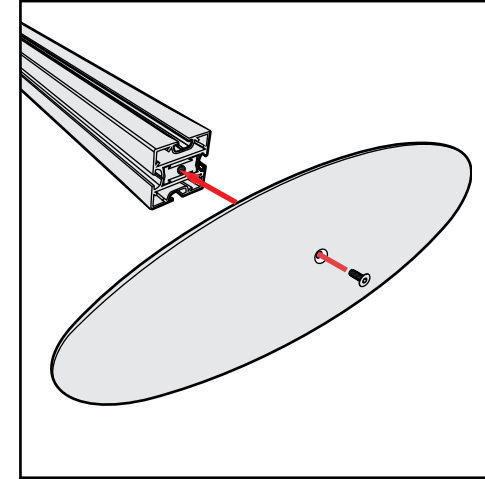

Base Plate & Extrusion Connection

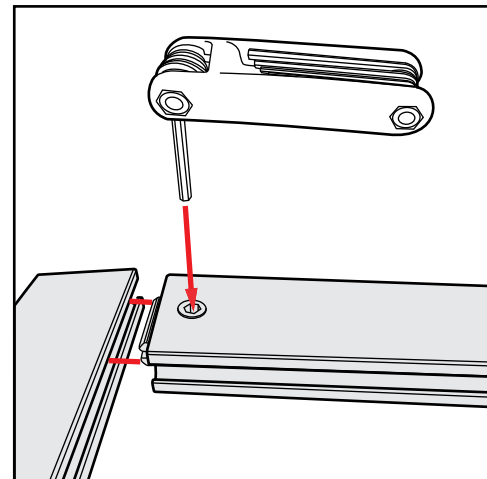

Extrusion & Lock Connection

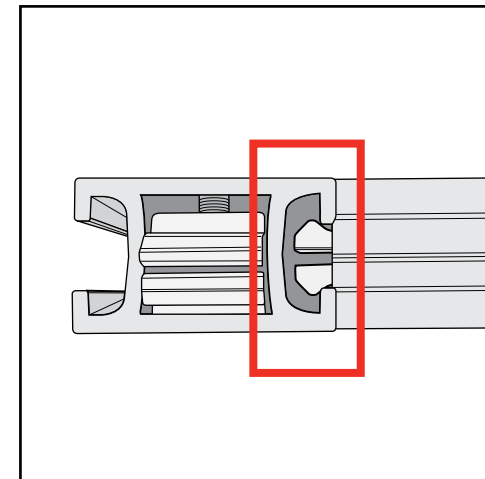

Engaged Lock



WARNING



DO NOT USE POWER TOOLS

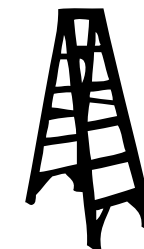

LADDERS OR LIFTS
MAY BE REQUIRED



ALL CONNECTIONS MUST
BE TIGHTLY SECURED

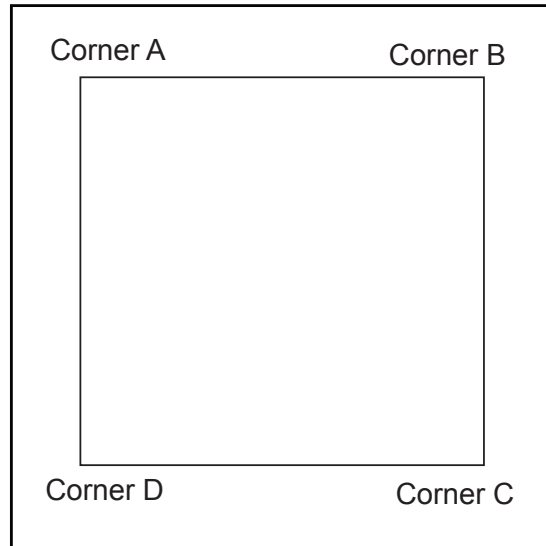

It is important to first insert graphic into each alternate corner then to the sides of the frame. If this is not done, graphic will not fit into the frame correctly.

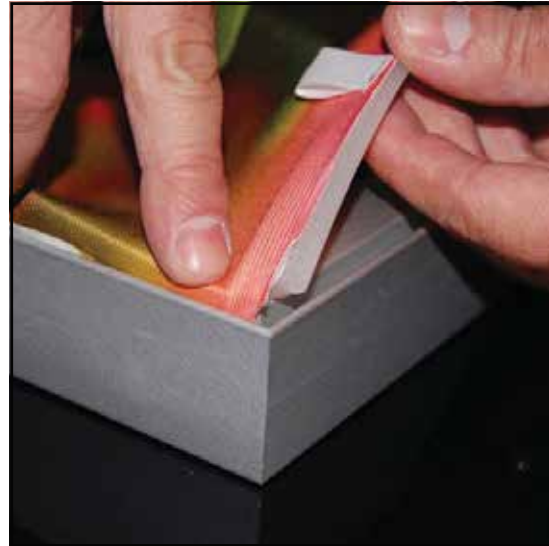

Step 1
Insert corner A. Turn edge of graphic so silicon welt is perpendicular to face of graphic. Insert narrow side of welt with fabric to outside into the channel. Repeat for other side of this corner.

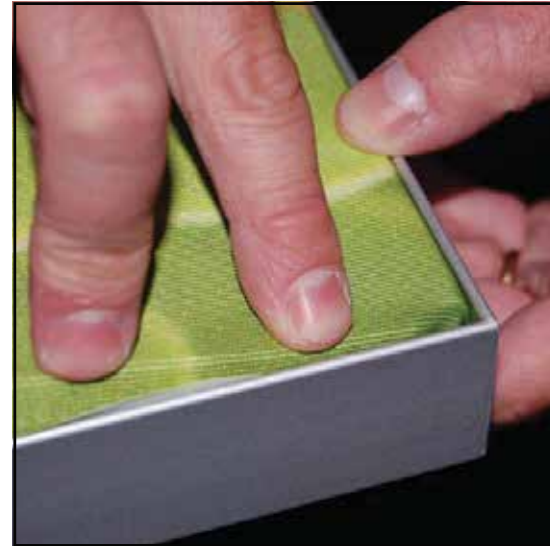

Step 2
Repeat Step 1 for opposite corner C, then insert corner B, followed by corner D, to complete the installation of the corners.



Step 3
Once all corners are inserted, press one silicon edge into channel from corners and work toward the center. Make sure welt is fully inserted into channel. Continue until all sides are done. Smooth out edges of graphic.

Graphic Removal

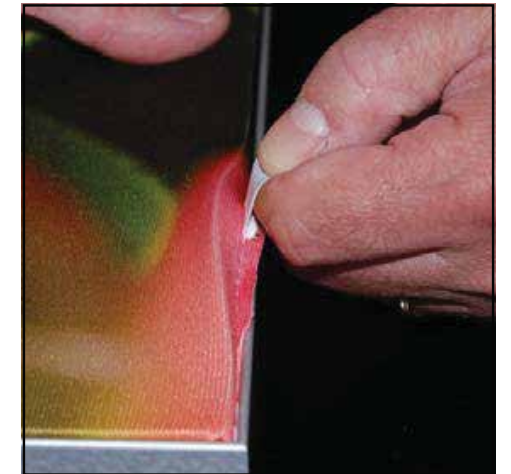

To remove the graphic from the frame, locate the fabric pull tab. Gently pull up on the tab to remove the fabric.

Top View of Each Level

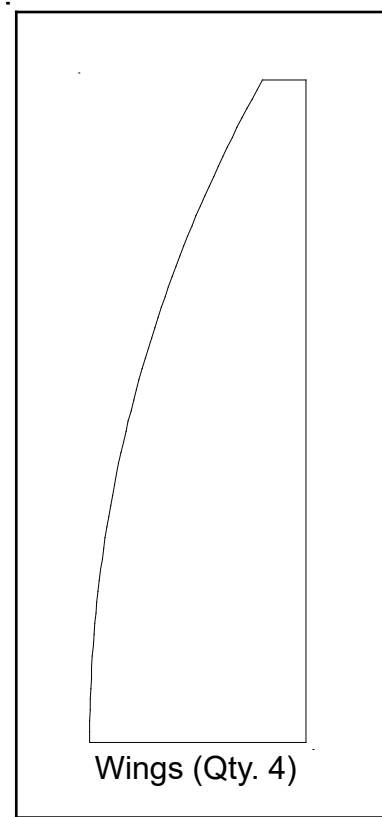

Level 1 (Bottom Level)

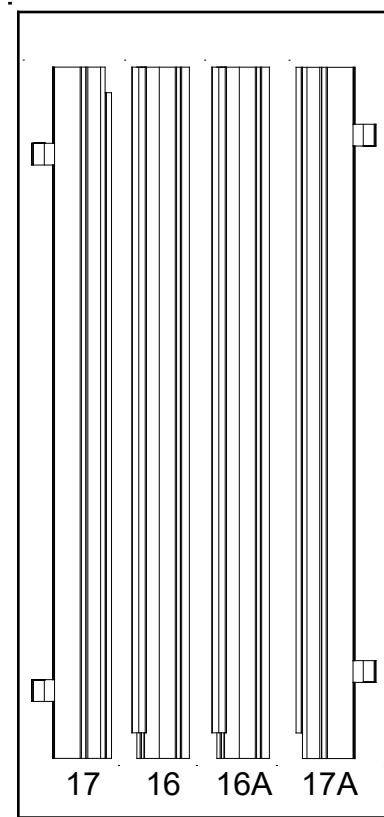

Level 2

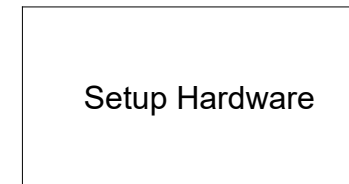
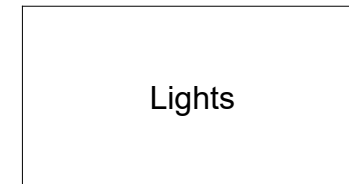
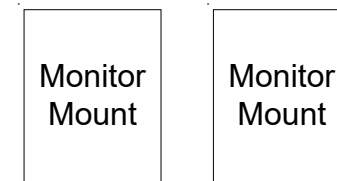

Top View of Each Level

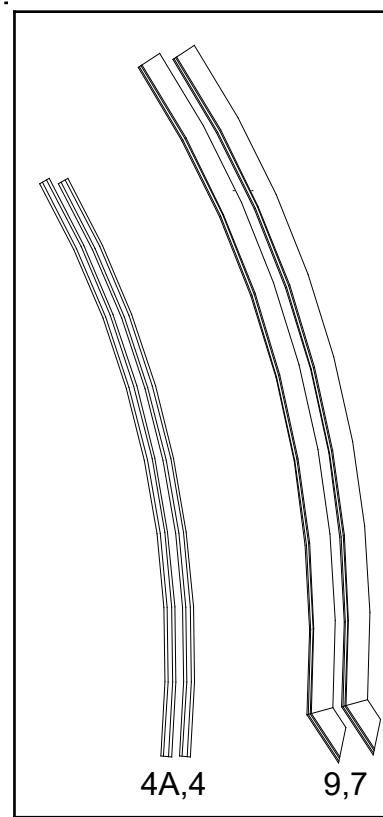

Level 1 (Bottom Level)

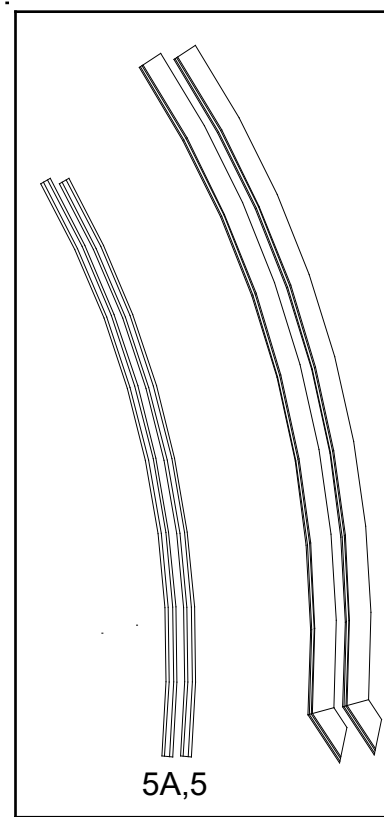

Level 2

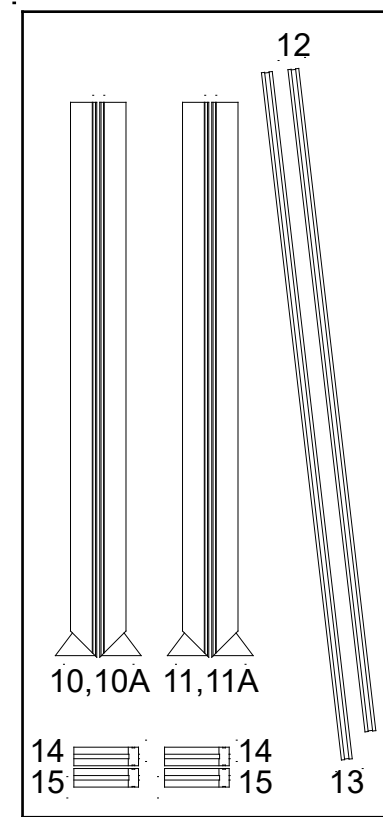

Level 3

Lights

Graphics

Top View of Each Level

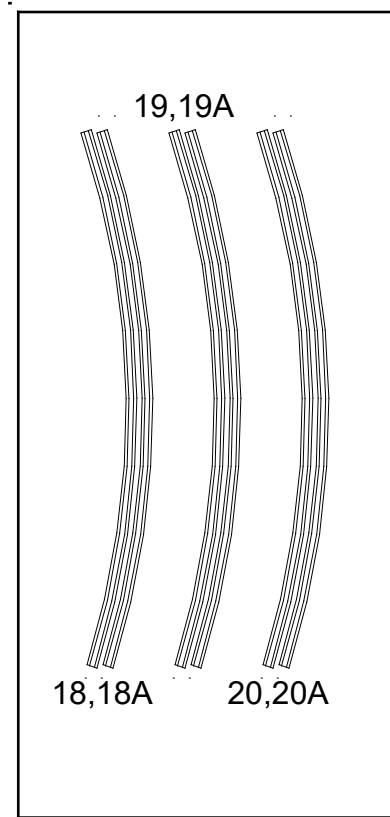

Level 1 (Bottom Level)

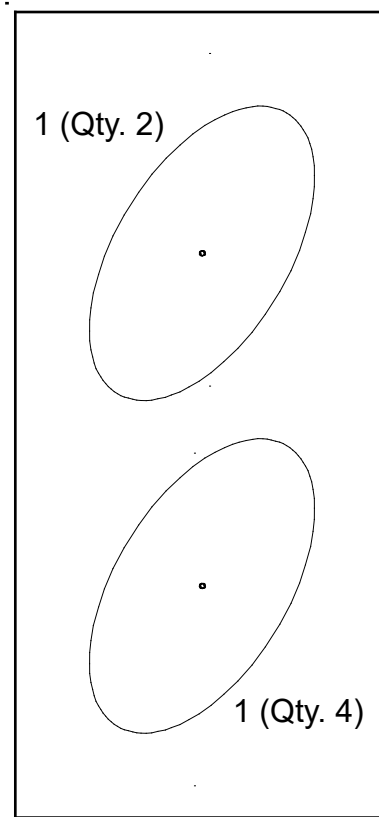

Level 2

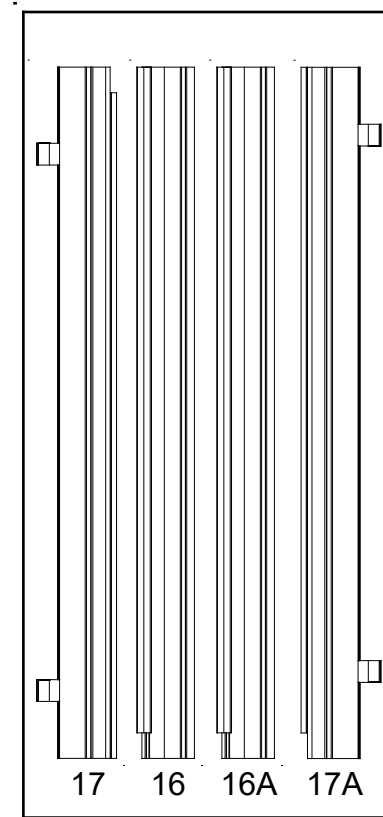

Level 3

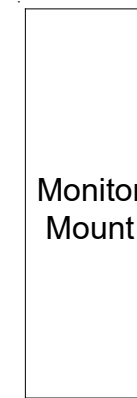

Top View of Each Level

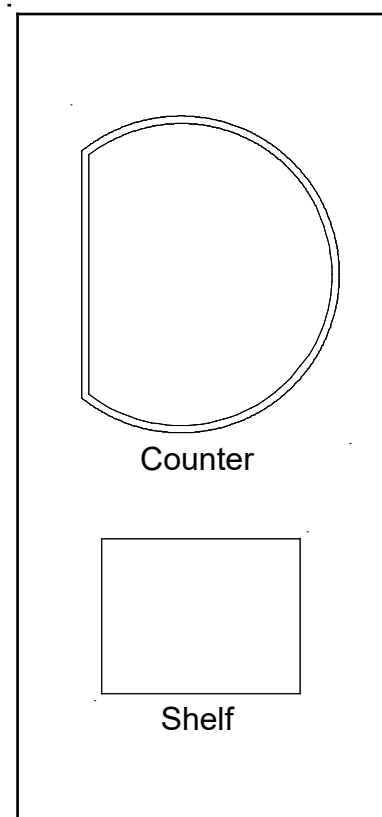

Level 1 (Bottom Level)

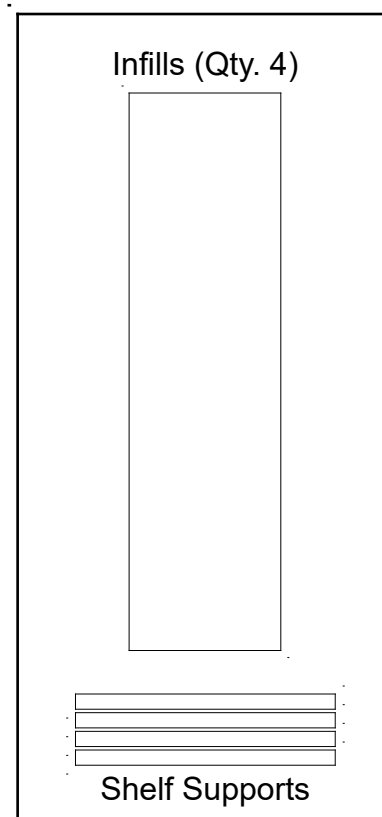

Level 2

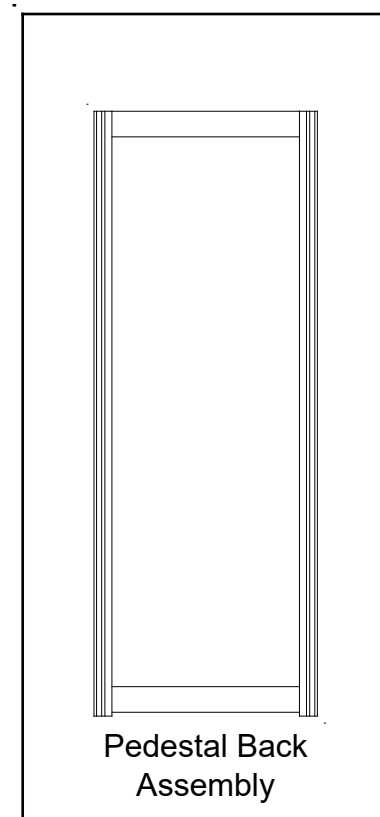

Level 3

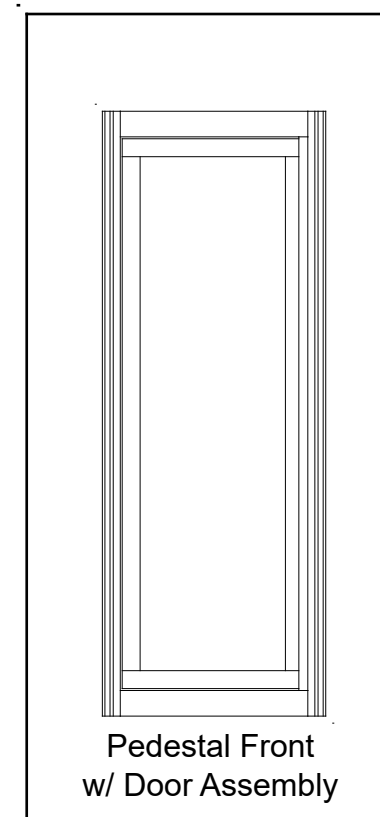

Level 4

Top View of Each Level

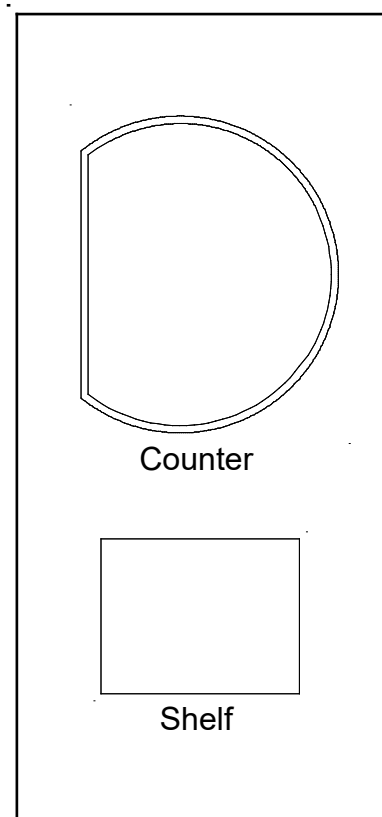

Level 1 (Bottom Level)

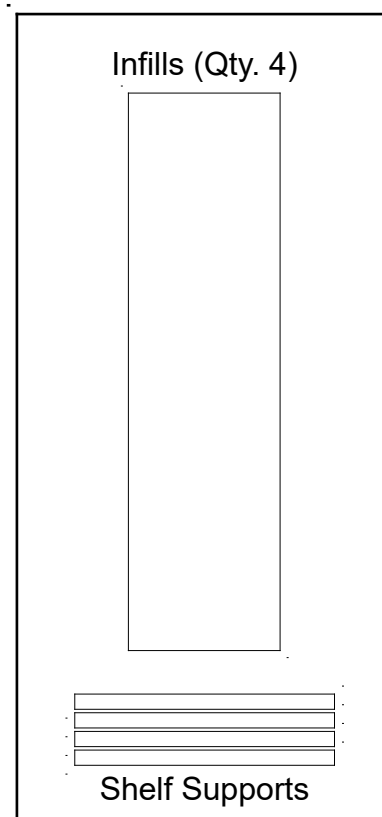

Level 2

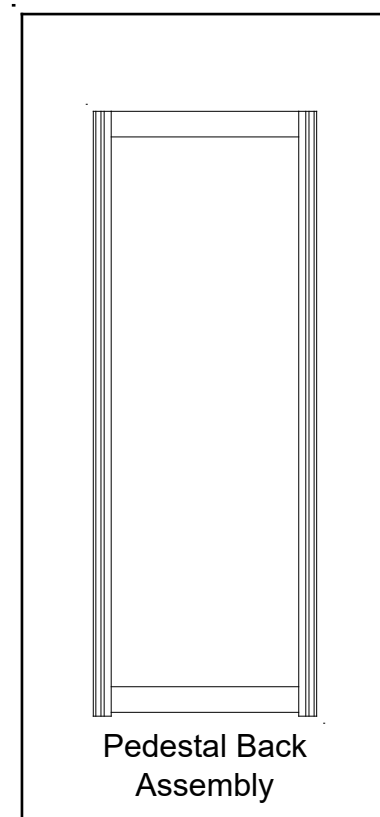

Level 3

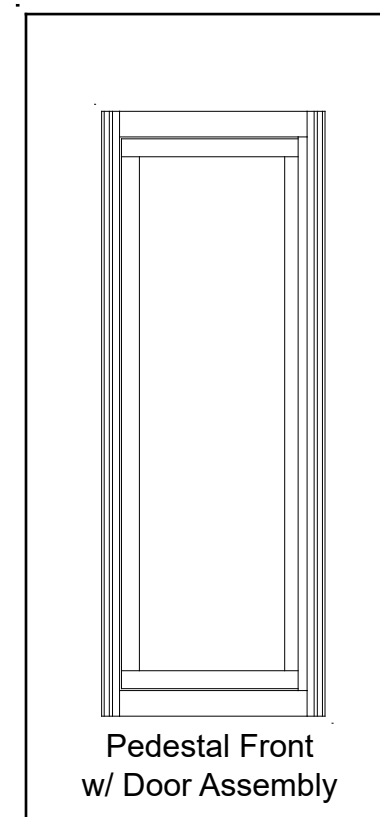

Level 4

Item	Qty.	Description
1	2	Base Plate
2,2A	1	48" h Vertical Extrusion
3,3A	1	48" h Vertical Extrusion
4,4A	1	41.7083" Curved Horizontal Extrusion
5,5A	1	41.7083" Curved Horizontal Extrusion

- Steps:
- 1) Attach base plates [1] to lower verticals [2] and [3], using bolts.
 - 2) Connect verticals [2] to [2A] and [3] to [3A]. See **Extrusion Connector** detail.
 - 3) Connect horizontals [4] to [4A] and [5] to [5A]. See **Horizontal Connector** detail.
 - 4) Attach horizontal assemblies [4/4A] and [5/5A] between vertical assemblies [2/2A] and [3/3A].
 - 5) Attach clamps to verticals [2/2A], where indicated. See **Clamp Attachment** detail.

Keep connectors attached to [2] [3] and [5], when packing.

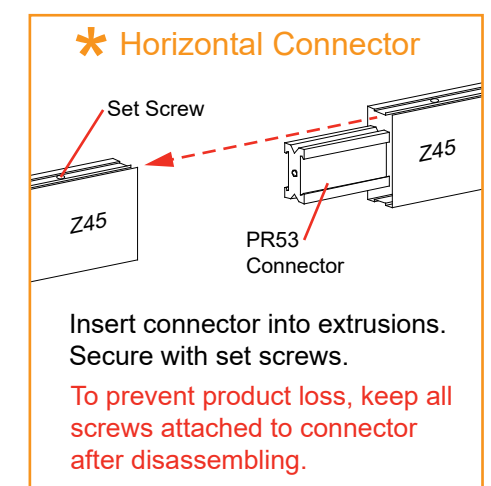
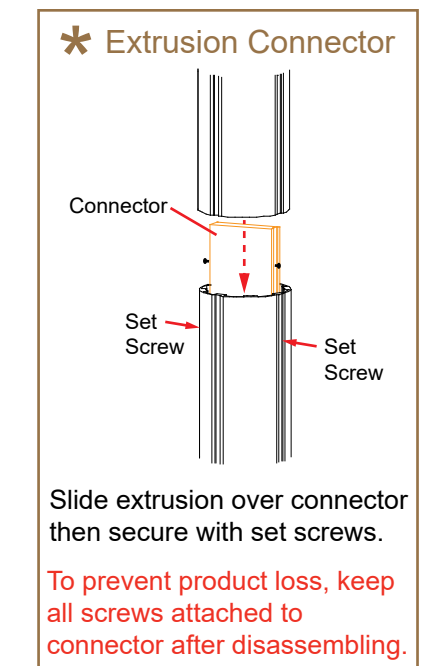
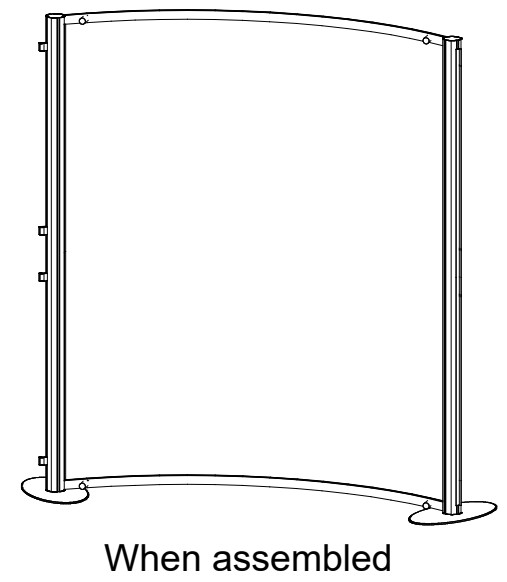
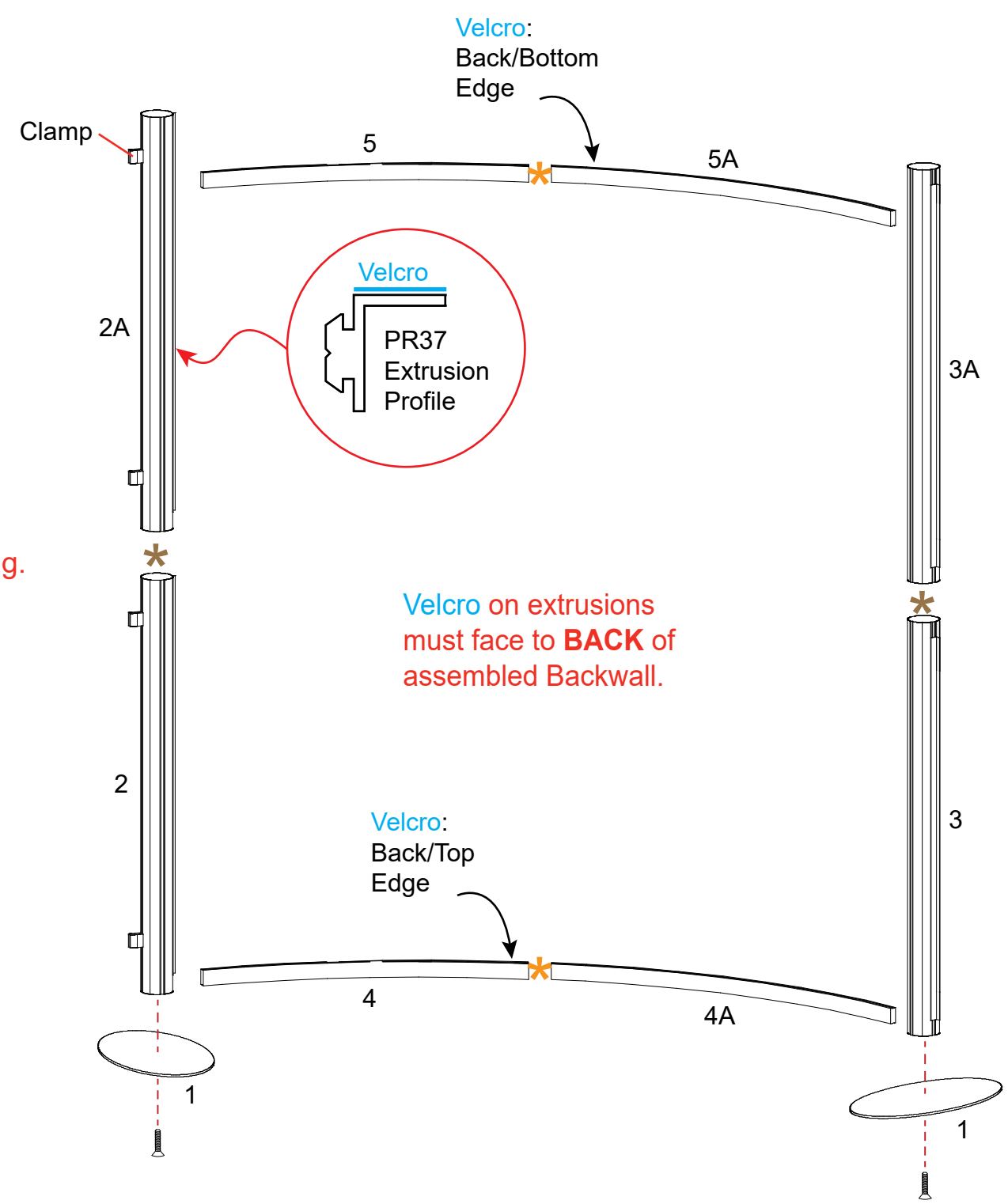
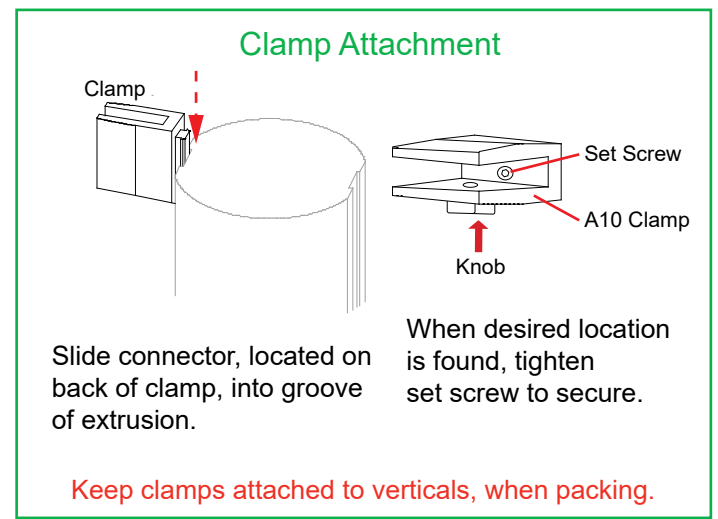

Item	Qty.	Description
6	1	48"h Curved Vertical Extrusion
7	1	48"h Curved Vertical Extrusion
8	1	48"h Curved Vertical Extrusion
9	1	48"h Curved Vertical Extrusion
10,10A	1	38.5"w Horizontal Extrusion
11,11A	1	38.5"w Horizontal Extrusion
12	1	46.2573"w Horizontal Extrusion
13	1	48"w Horizontal Extrusion

Steps:

- 1) Assembled extrusions together, as shown. See connection details.
- 2) Connect blocker fabric to assembled frame.
- 3) Install SEG graphic to assembled frame. See SEG Graphic Installation sheet for instruction.

*** TSP46 Straight Connection**

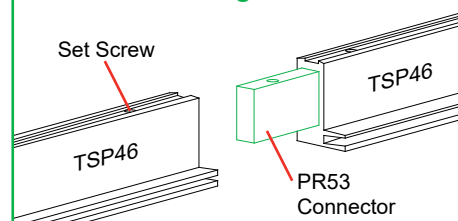

Insert connector into extrusions. Secure with set screws.

To prevent product loss, keep all screws attached to connector after disassembling.

*** TSP46 Corner Connection**

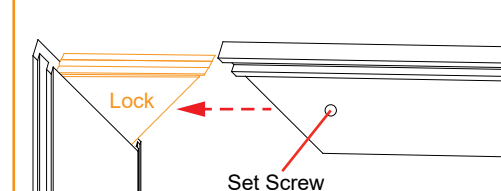

Slide end of extrusion over Lock. Tighten set screw to secure extrusions together.

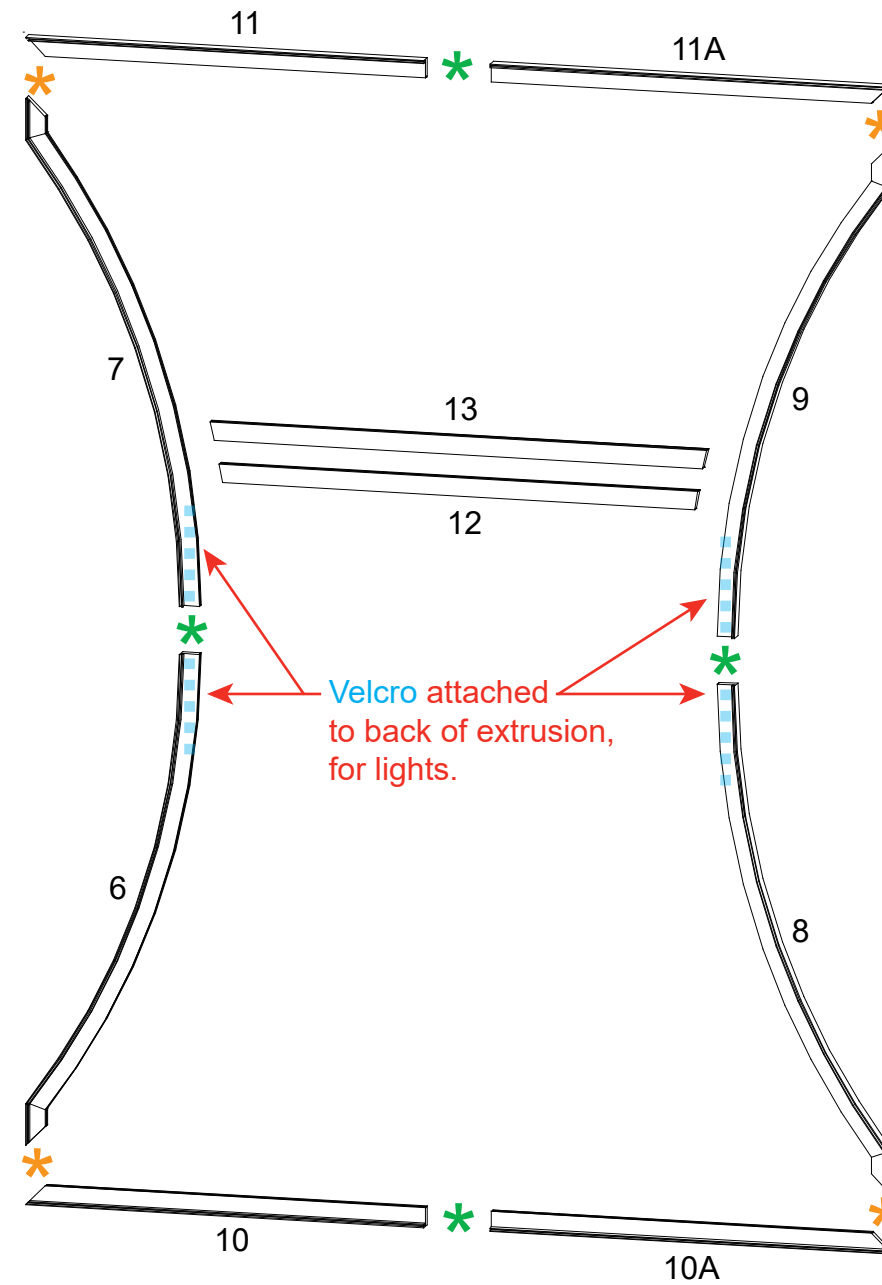

Front View

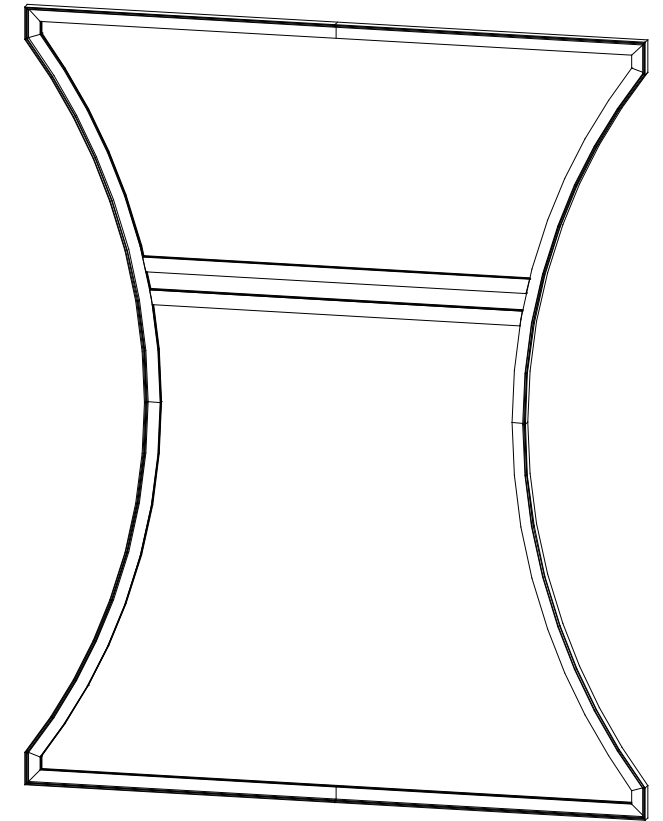

When assembled
Front View

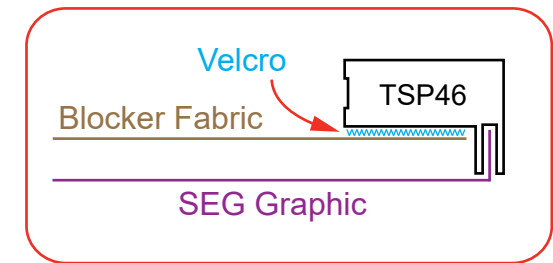

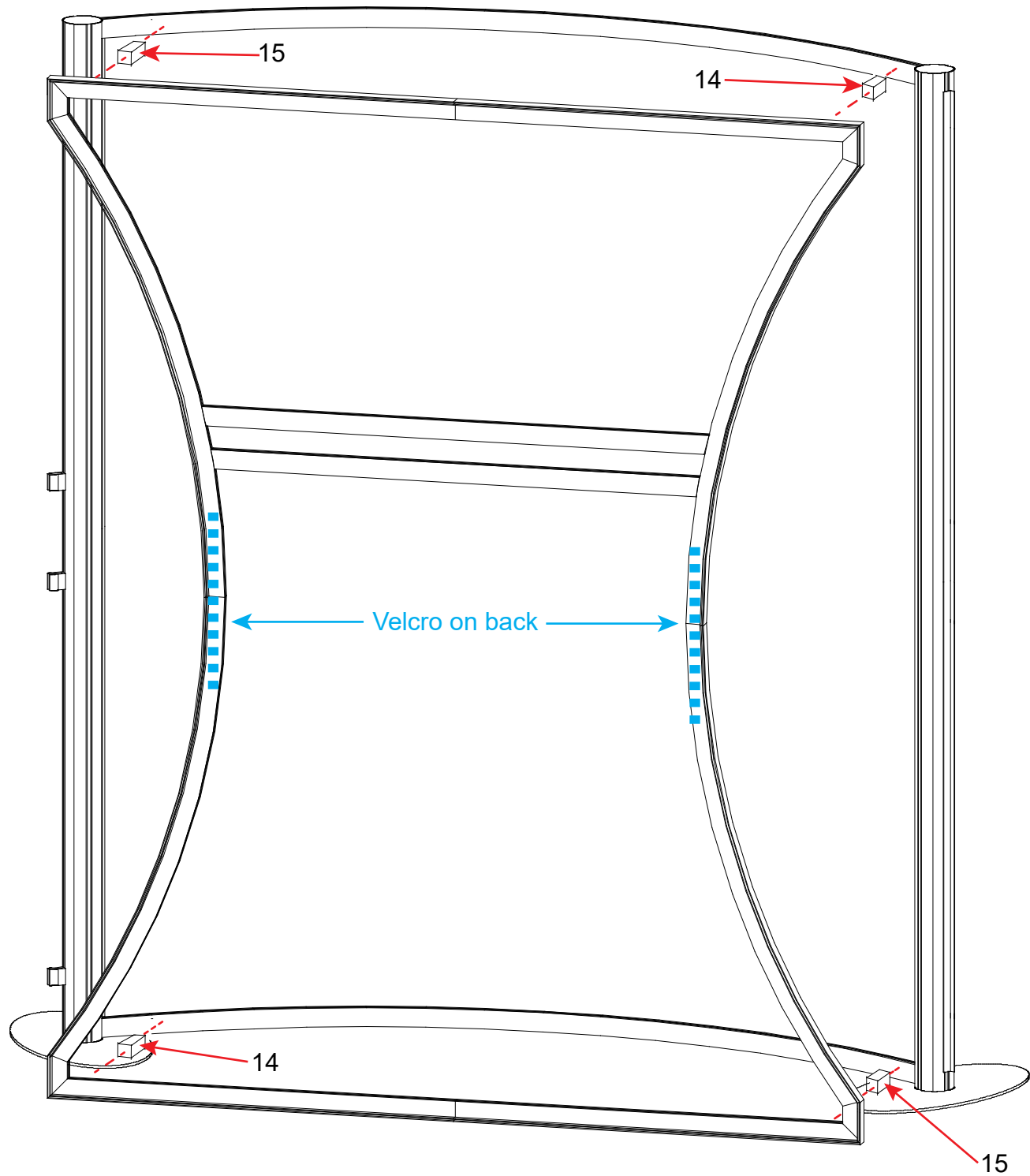

Item	Qty.	Description
14	2	4.5" Horizontal Extrusion
15	2	4.5" Horizontal Extrusion

- Steps:
- 1) Attach assembled frame to assembled backwall, using horizontals [14] and [15].
 - 2) Attach lights to **Velcro** on back of assembled frame.

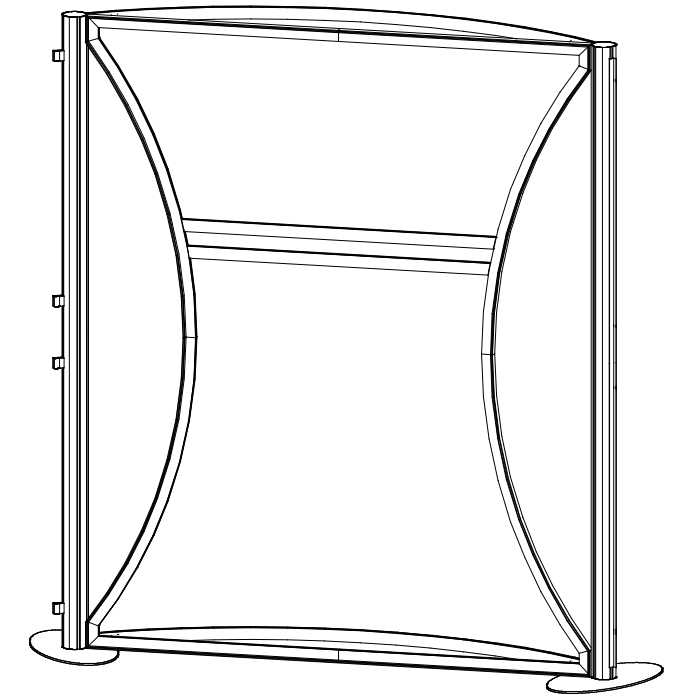

When assembled

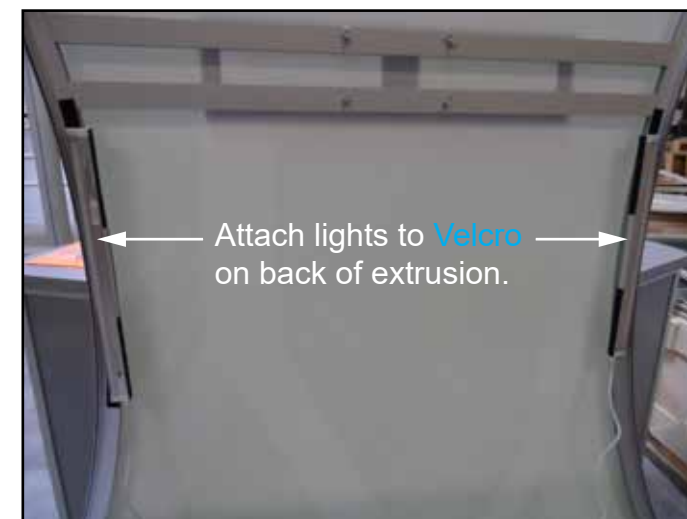

Steps:

- 1) Connect Light to the upper horizontal of SEG Frame.
See [Light Connection](#) detail.
- 2) Attach wings to clamps on verticals [2/2A].
See [Clamp Attachment](#) detail.
- 3) Attach monitor mount to horizontals [12] and [13].
See [Monitor Mount Attachment](#) detail.

Clamp Attachment

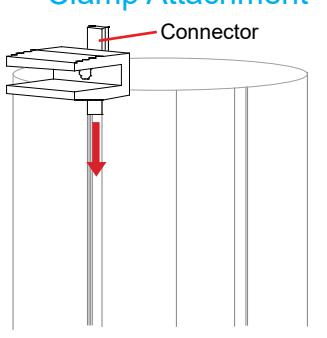

Connector

- 1) Slide connector of clamp into extrusion groove.
- 2) Tighten set screw when A10 is in desired location.
- 3) Insert wing into clamp.
- 4) Tighten knob on clamp to secure wing in place.

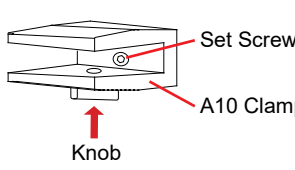

Set Screw
A10 Clamp
Knob

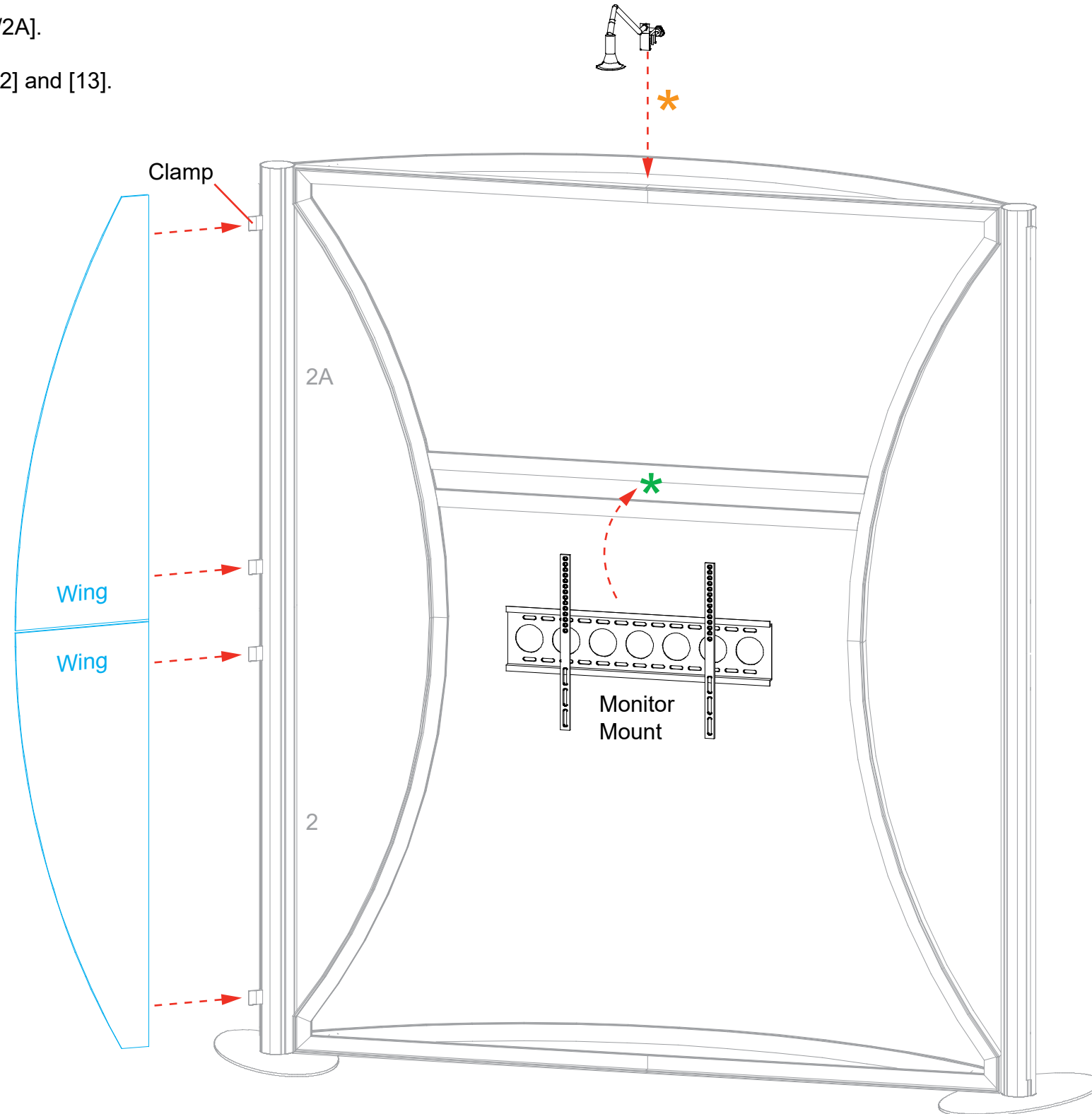

*** Light Connection**

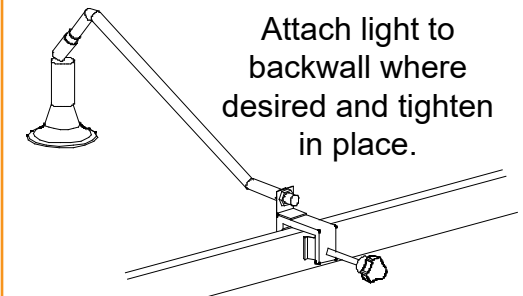

Attach light to backwall where desired and tighten in place.

*** Monitor Mount Attachment**

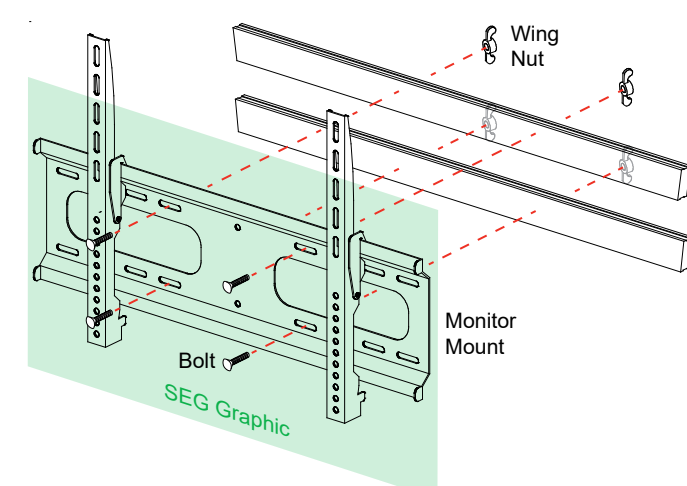

Wing Nut
Monitor Mount
Bolt
SEG Graphic

Attach monitor mount to horizontal extrusions, using bolts and wing nuts.
Note: Monitor mount attaches over SEG graphic.

Steps:

- 1) Attach base plates [1] to lower verticals [16] & [17], using bolts.
- 2) Connect verticals [16A to 16] and [17 to 17A].
- 3) Connect curved horizontals [18 to 18A] and [19 to 19A].
- 4) Attach curved horizontal assemblies [18/18A] & [19/19A] between verticals [3/3A] & [16/16A].
- 5) Attach horizontals [20] & [20A] between verticals [16/16A] & [17/17A]
- 6) Connect graphic to Velcro on back of assembled frame.

Item	Qty.	Description
1	2	Base Plate
16/16A	1/1	48"h Round Vertical Extrusion
17/17A	1/1	48"h Round Vertical Extrusion
18/18A	1/1	38" Curved Horizontal Extrusion
19/19A	1/1	38" Curved Horizontal Extrusion
20/20A	1/1	38" Curved Horizontal Extrusion

Velcro on extrusions must face to **BACK** of assembled Backwall.

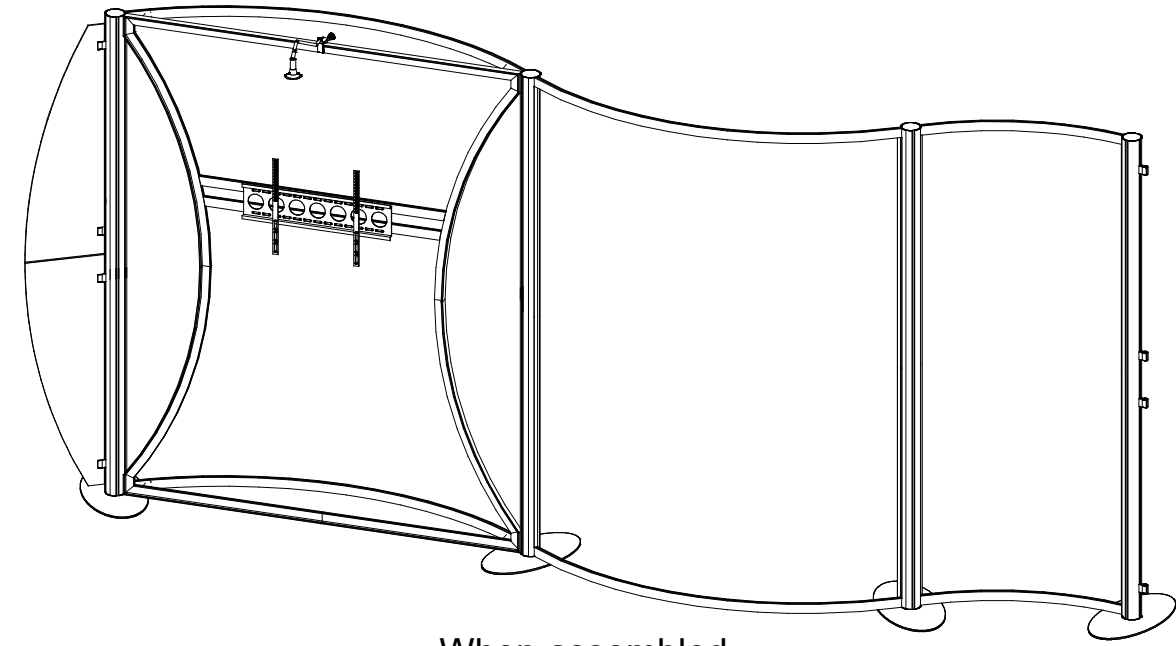

When assembled

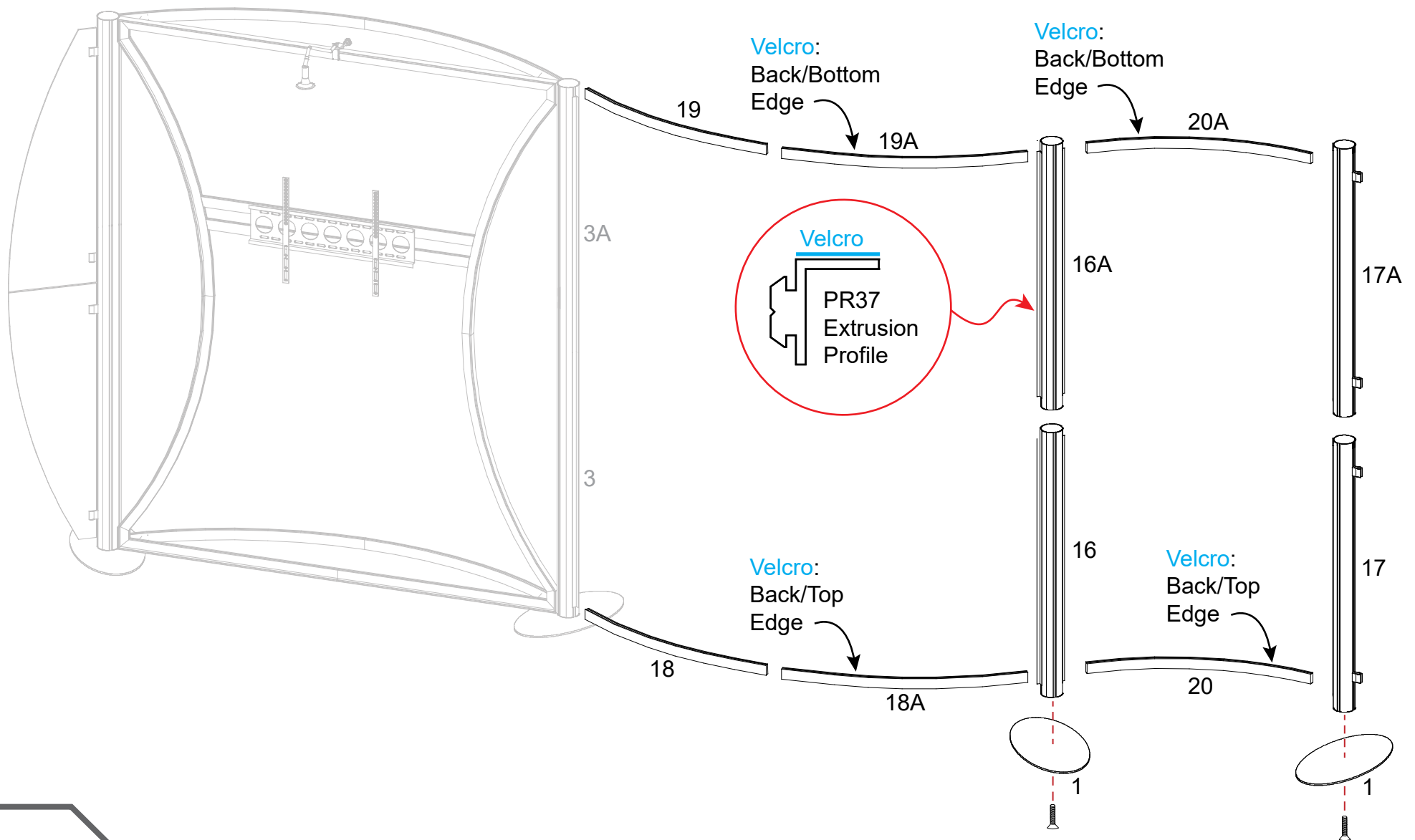

- Steps:
- 1) Connect lights to upper horizontals, where indicated.
See **Light Connection** detail.
 - 2) Connect wings to vertical [17/17A], using clamps.
See **Clamp Attachment** detail.
 - 3) Attach monitor mounts to verticals, where indicated.
See **Monitor Mount** detail.

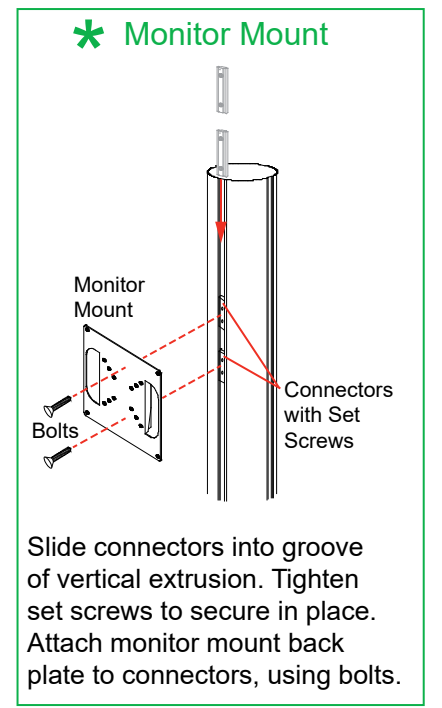
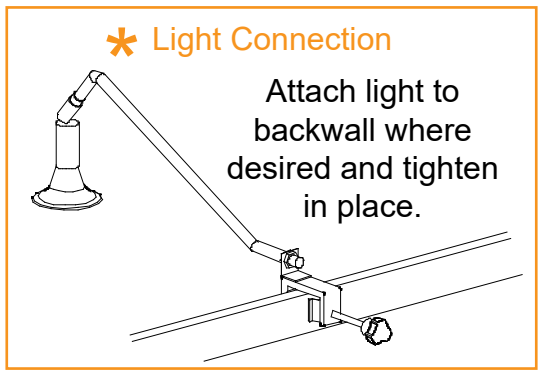
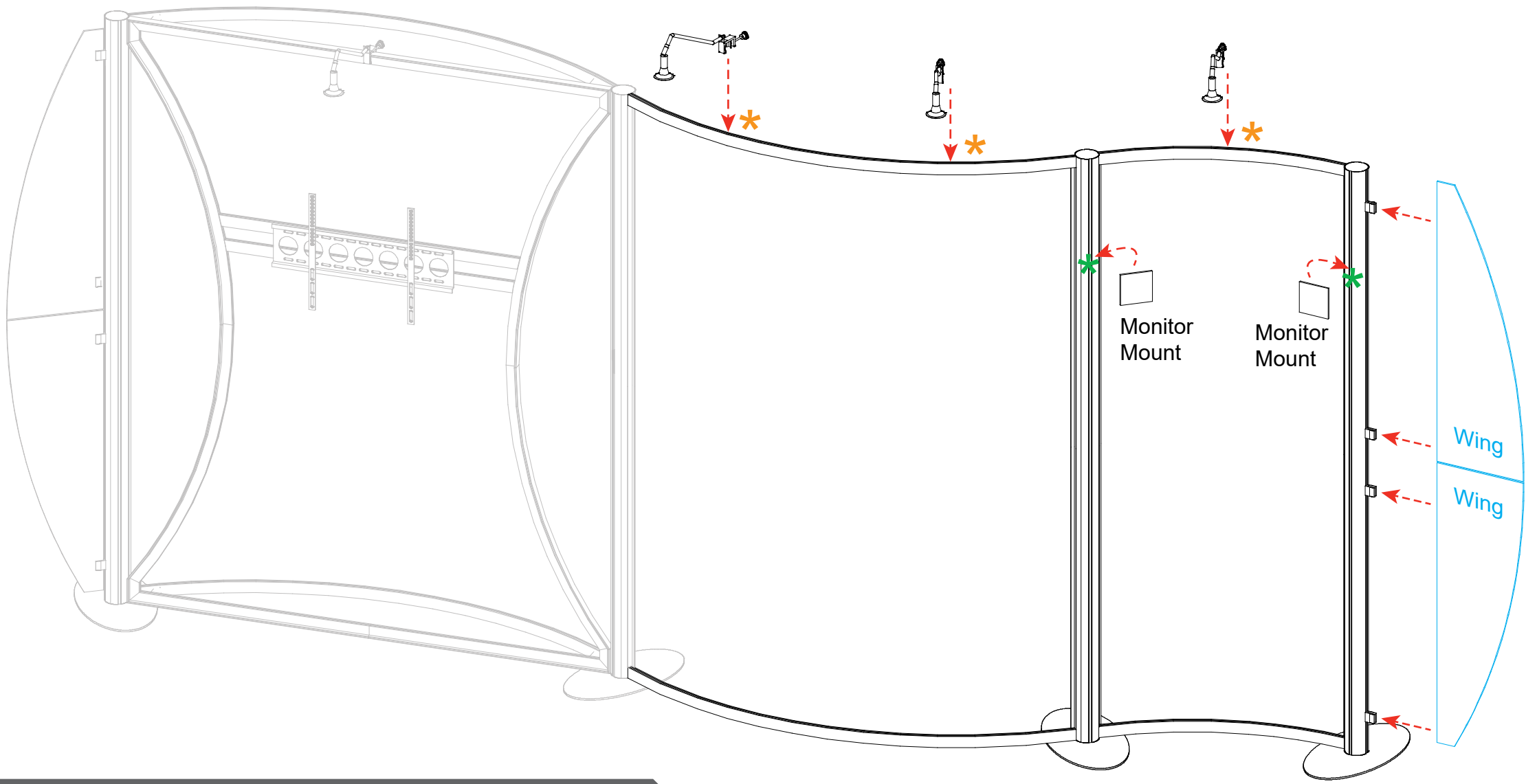
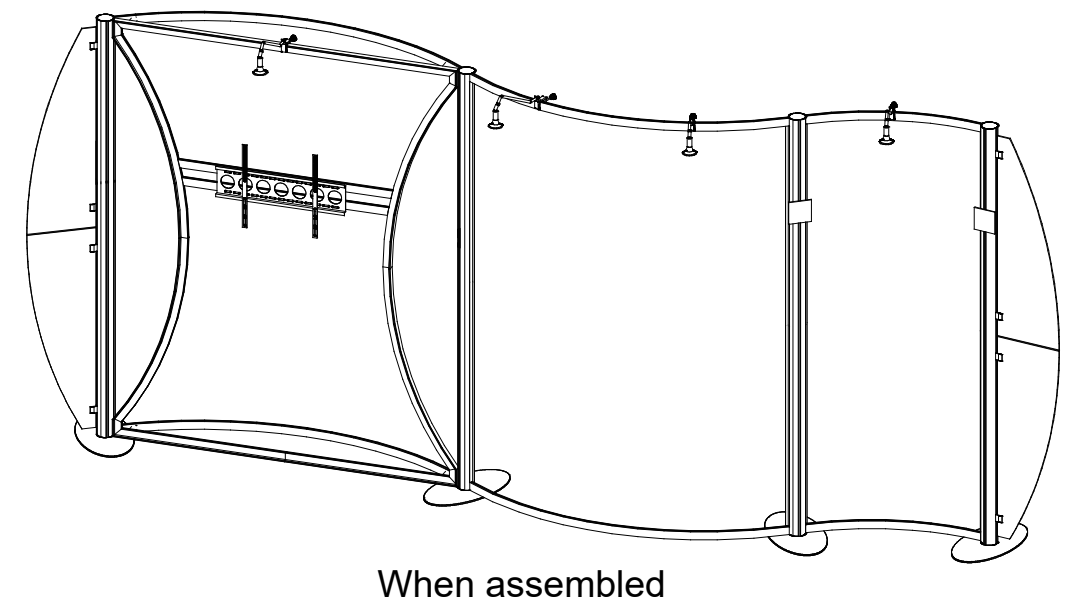
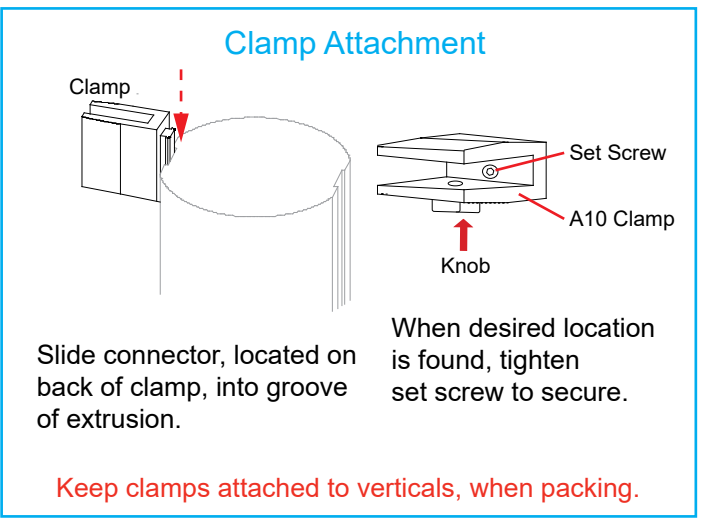

Item	Qty.	Description
21	2	42" h Corner Vertical Extrusion
22	2	42" h Corner Vertical Extrusion
23	2	42" h Corner Vertical Extrusion
24	2	42" h Corner Vertical Extrusion
25/25A	8	13" w Horizontal Extrusion
26/26A	8	10" w Horizontal Extrusion

- Steps:
- 1) Attach lower horizontals [25] and [26] between verticals [21] [22] [23] and [24].
 - 2) Connect door to vertical [24]. See [Door Connection](#) detail.
 - 3) Slide infills between verticals [21] [23], [21] [22], and [22] [24], making sure Velcro is facing inward.
 - 4) Attach upper horizontals [25A] and [26A] between verticals [21] [22] [23] and [24], to secure infills.
 - 5) Connect shelf supports to Velcro.
 - 6) Place shelf on top of shelf supports.
 - 7) Lock counter to horizontals [26A]. See [Counter Lock](#) detail.

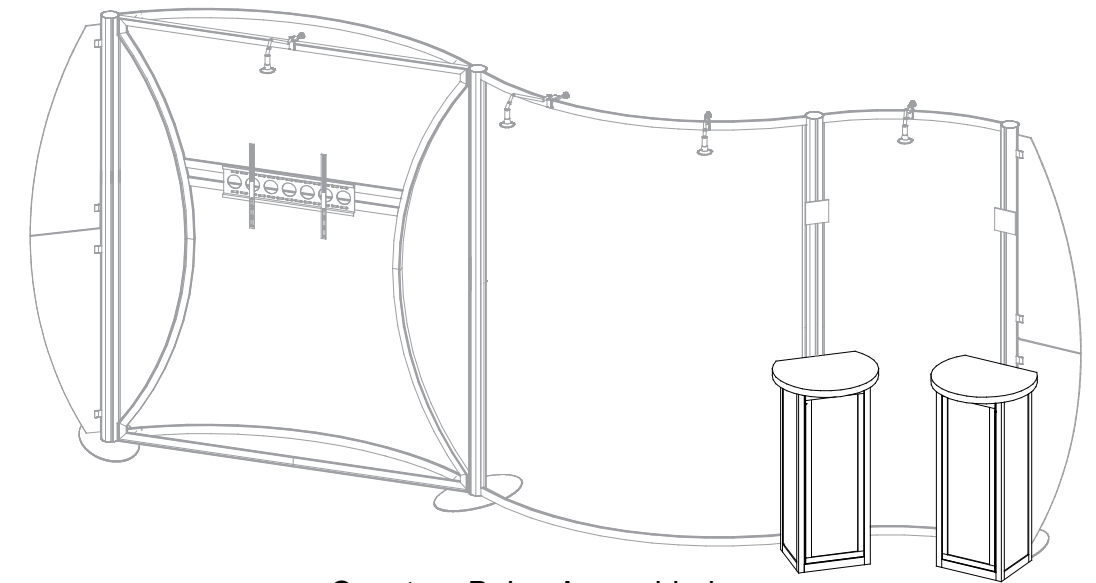

Counters Being Assembled are Highlighted in BLACK

